

DWG. NO.

SH

REV.

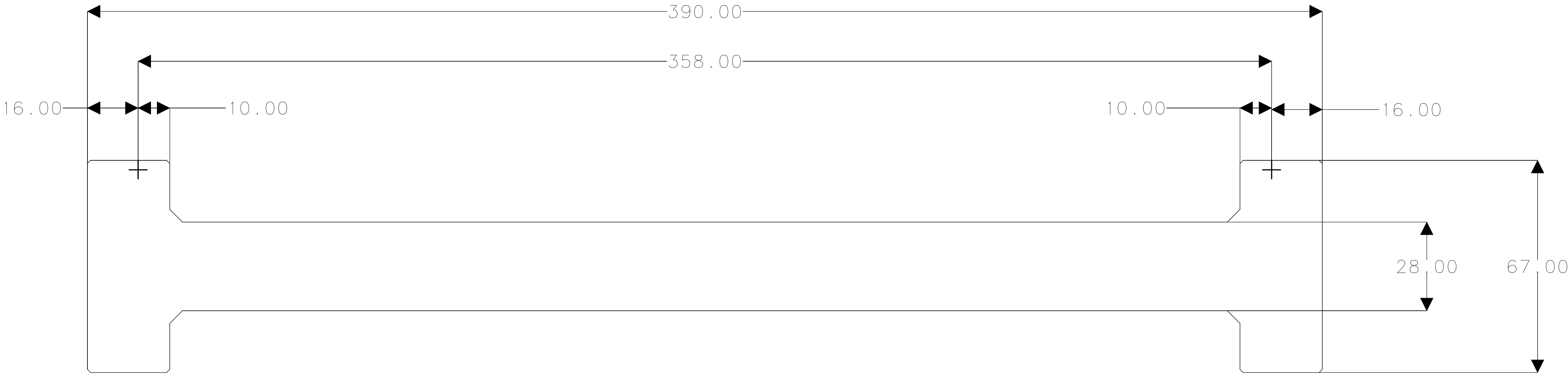

Stiffener
1mmThick

Stiffener
1mmThick

BOARD's DRILL SCHEDULE

DRILL SYMBOL	DRILL SIZE	COUNT	PLATED	Tolerance	COMMENT
○	.20193	1645	YES	---	
⊞	1.27	100	YES	---	
Φ	3.048	4	YES	---	

Layer Order
5-Layer Flex PCB

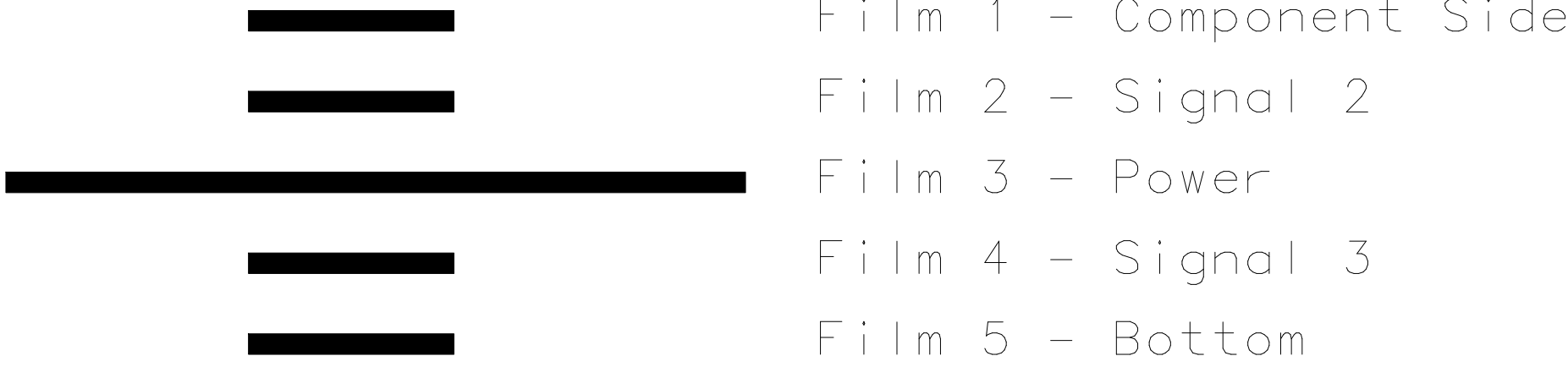

Board Characteristics

0. Material - RF775
1. All dimensions in mm, unless specified
2. Minimum trace width: 4 mils
3. 0.5 Oz Copper on all layers
4. Silkscreen on Component Side.
5. Polyimide Coverlay (Kapton Soldermask) on Top and Bottom, as per Gerbers
6. Soft Au finish (ENIG) for Al wire bonding and hand soldering on all pads.
7. Place two Stiffeners on Top (Component) side of Flex PCB.
- 7.1. Stiffener Dimensions and position as shown.
8. Total flex circuit thickness cannot exceed 0.012", not including stiffener

UNLESS OTHERWISE SPECIFIED DIMENSIONS ARE IN INCHES TOLERANCES ARE: FRACTIONS DECIMALS ANGLES . XX . XXX DO NOT SCALE DRAWING			CONTRACT NO.		UNIVERSITY OF CHICAGO ELECTRONICS DEVELOPMENT GROUP										
			APPROVALS		DATE	TITLE 1Kx6K CCD Flex Extension Specification Drawing									
TREATMENT			DRAWN	M. Bogdan	3/11/19		SIZE B			FSCM NO.		DWG. NO. 2947		REV. A	
FINISH			CHECKED	M. Bogdan	3/11/19										
SIMILAR TO			ISSUED				SCALE		1 / 1				SHEET		